

DIGIMAPS - 'SQUARE OF THE
YEAR'

Look at this image. What do you think it is?

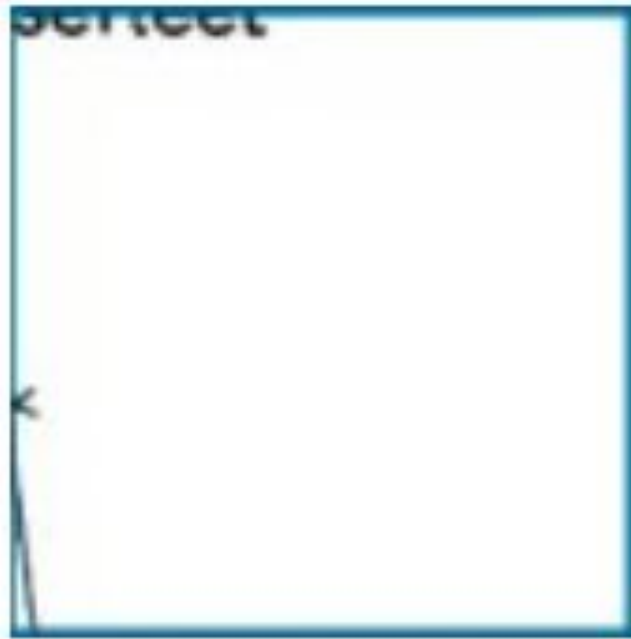

It is SE8322 which has been nominated the least interesting map square at 1: 50 000 scale. All that is shown a small section of electricity transmission line and the edge of some text. **INSERT A SCREENSHOT OF THE GRID SQUARE FROM DIGIMAPS BELOW (with a marker of your choice)**

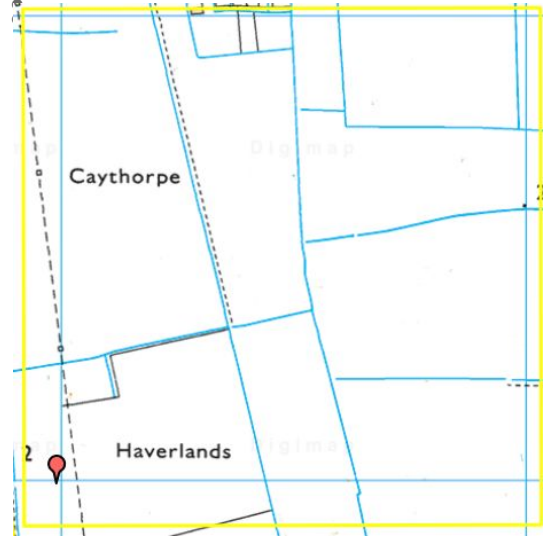

WHAT THE GRID SQUARE LOOKS LIKE IN REAL LIFE:



Officially the dullest Geograph square in the UK.

Yes really. According to the OS who have scanned the whole of the UK maps by computer, this is the most featureless square in the UK. In the distance there is a row of pylons and one of them stands in the far corner of the square. The land is billiard table flat and there are no drainage ditches in it to speak of.

The mud is a rather nice shade of brown. It really is that dull.

Now zoom in and you will see that the square is far less empty of features than first suggested. What additional detail is added or taken away as they change the zoom level?

TAKE YOUR NEXT SCREEN SHOT (insert here):

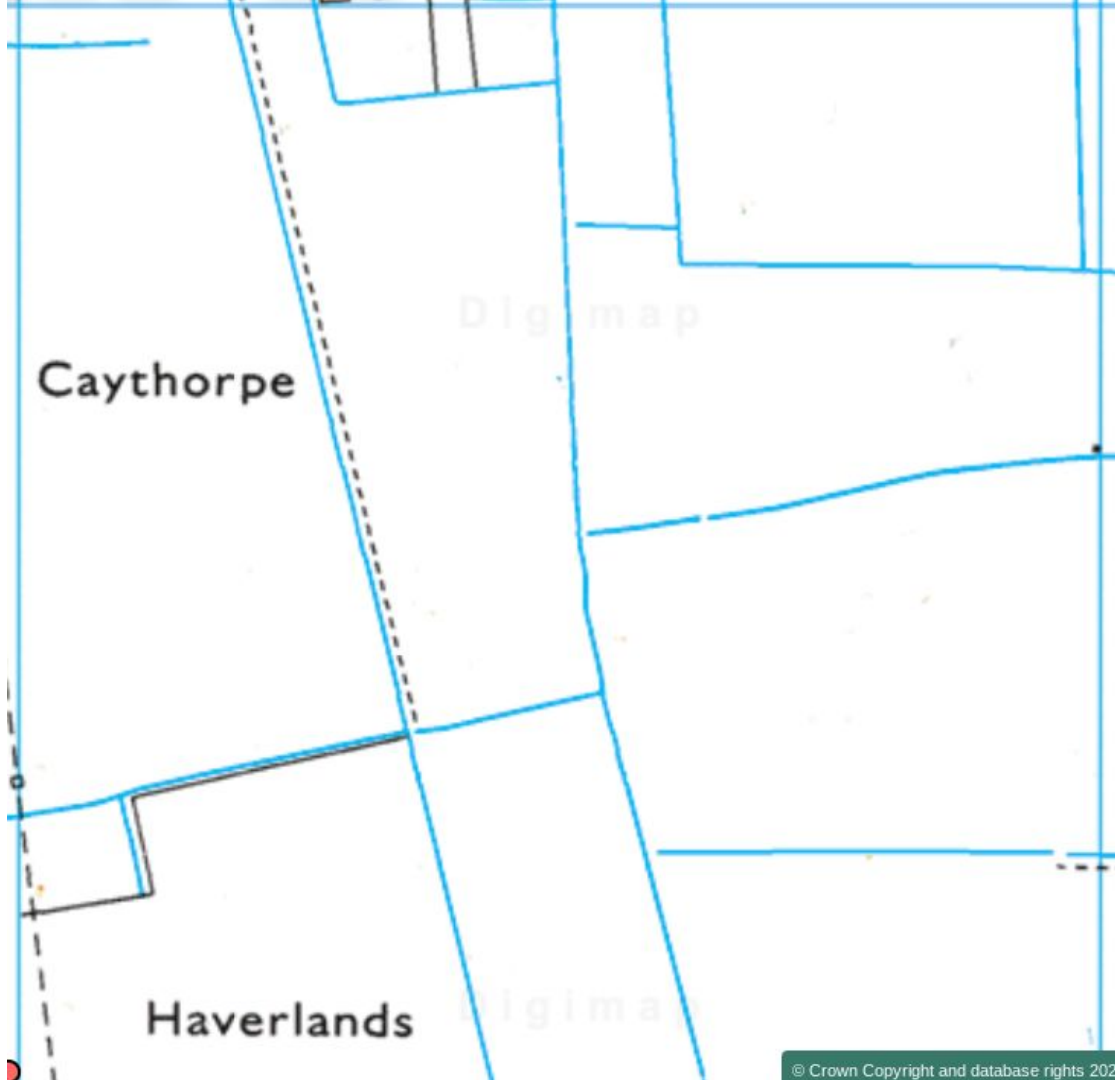

Caythorpe

Haverlands

Having considered what makes a grid square dull. You now need to find one that you find most interesting and enter it for 'Square of the Year'. using the hand-out(s) provided.

I suggested that you all use 1 km grid squares mapped at 1:25 000, and that you use the second level of zoom, so that results are comparable to each other. (Click the 'i' button in the toolbar to help see the scale)

FEELING STUCK?

The following may help to give you some ideas:

- Edinburgh Castle NT 250 730
- London Eye, Thames and Parliament TQ 300 790
- GCHQ SO 909 220

SCREENSHOT OF YOUR 'SQUARE OF THE YEAR' (AS ORDNANCE SURVEY)

You may want to highlight the edge of your square using the tool 'Draw an area'. Make sure you select 100% transparency, and choose your outline colour and line width before you draw. A thick red line works well.

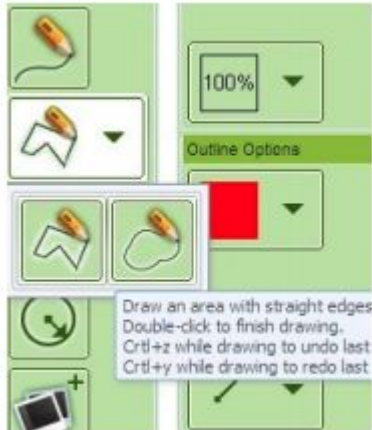

Screenshot:

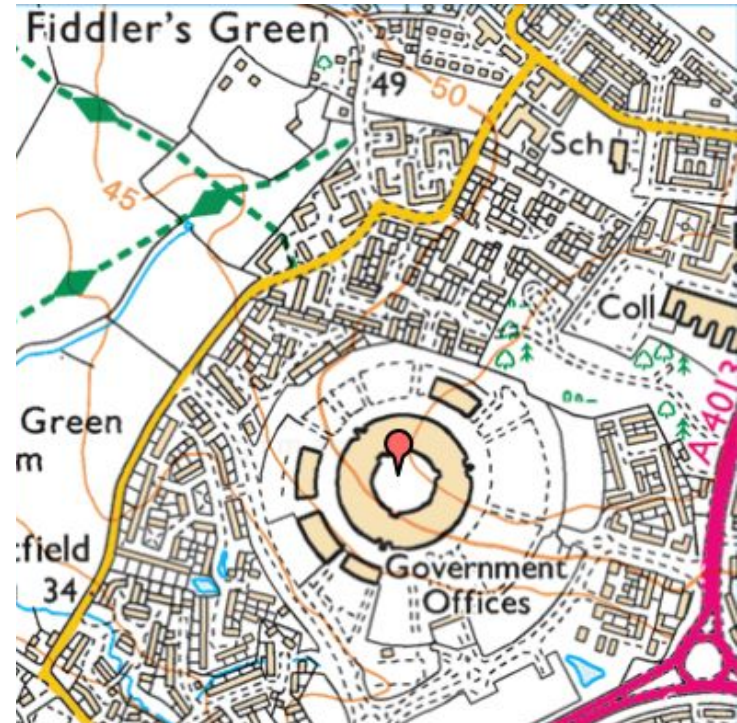

SCREENSHOT OF YOUR 'SQUARE OF THE YEAR' (AS AERIELX)



On the next slide you should write a description of your square which makes it sound as if it is the best square of any on the whole map. I encourage you to use descriptive language to explain why the features are impressive, large, beautiful, stunning and so on.

DESCRIPTION OF 'SQUARE OF THE YEAR'

I have chosen this one as square of the year as the structure of the building (GCHQ) is unusual but very futuristic. It also clearly represents the “spy” side of it with it’s subtle but interesting shape.